

431-LU20 LiftLap Cradle

Before assembly

Please spend some times to read this and follow the procedures step by step.

Some panels are viewed differently from the exploded drawing below. This is for extra clarity.

Do not discard any of the packaging until you have checked all the parts and the package of fittings. If you are missing any of the parts, please contact the store from which you purchased your products. The staff will do their best to help you.

Parts Check-List

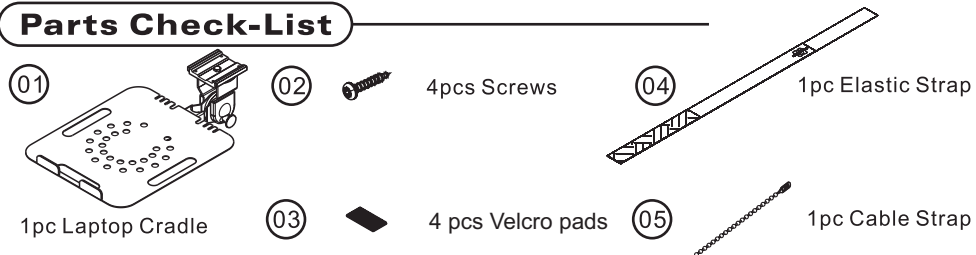

- 1** 4 pcs screws to secure the holder under the desk!

- 2** Pull out the handle and then move the metal tray upper 90 degree.

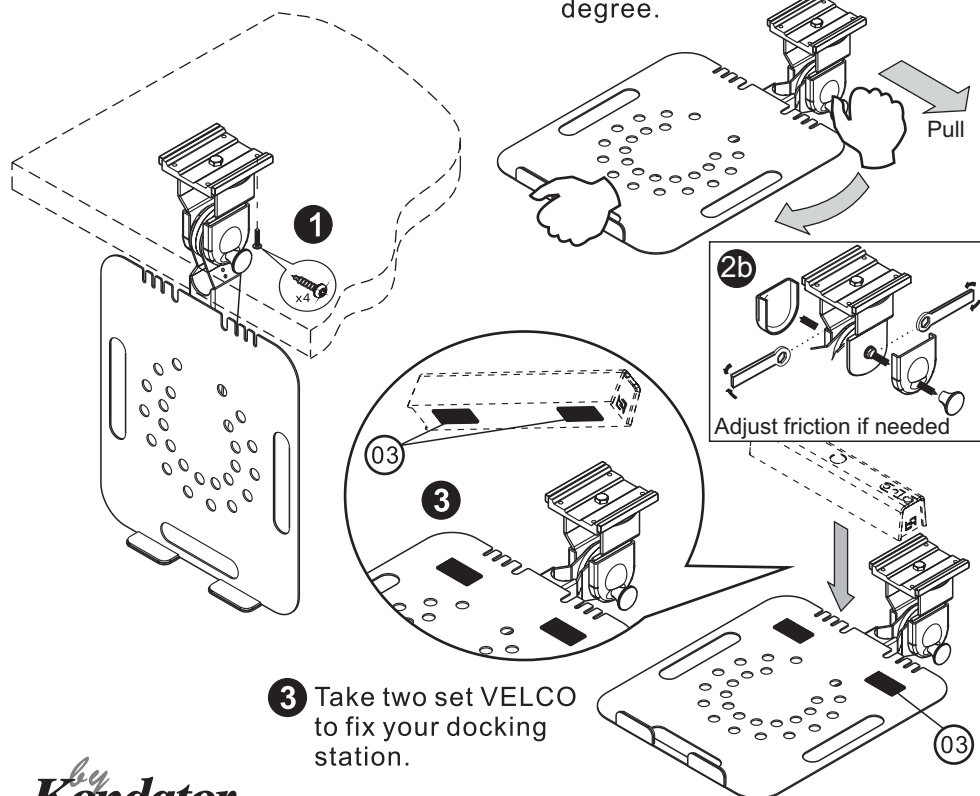

- 3** Take two set VELCO to fix your docking station.

431-LU20 LiftLap Cradle

- 4** Take the elastic strap goes through two holes on the metal tray by stretching the strap carefully.

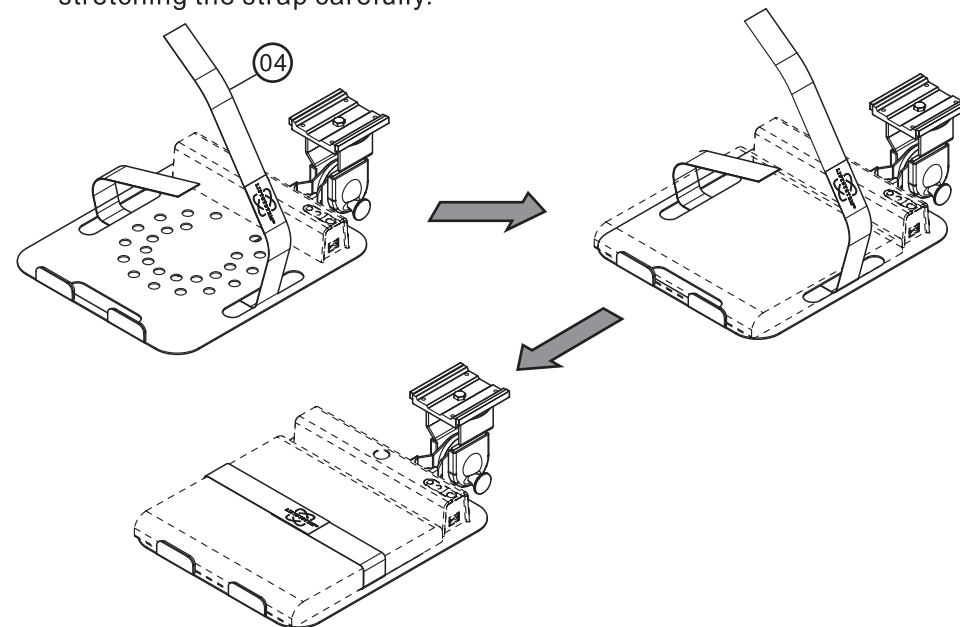

- 5** Use small cable strap to organize cable first then use cable management collect them beside the arm.

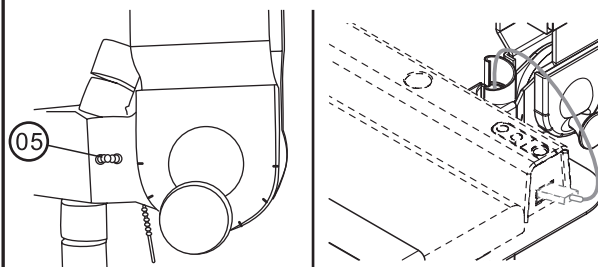

- 6** Note: As an option for mobile montage, use additional LiftSystem Track Codeno 430-WA11

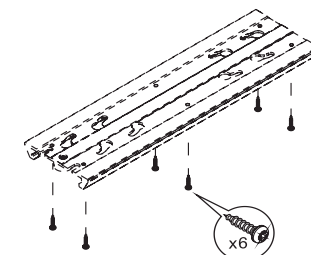

CLEANING RECOMMENDATION:

Regular cleaning with a clean dry cloth is usually sufficient, but for stubborn marks, wipe over gently with a clean damp cloth. Never use strong detergents or abasive cleaners as these may damage the surface finish of your furniture.

